



Plug and play



Automatic connection

# Wireless CarPlay Dongle

Convert Factory Wired CarPlay to Wireless

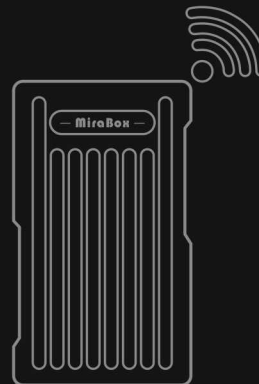

Model : HSV283

### Pre-conditions:

1. Before connecting the HSV283 wired to wireless box, please confirm that the device you are currently using supports wired connection to I-Phone CarPlay.
2. The box is connected to the corresponding interface that can be connected to the phone (Some cars have multiple USB ports, there may only be one that can connect to a mobile phone, usually marked.)

### ONE. Wired to wireless box connection main interface and Webpage setting instructions:

#### 1. Instructions for connecting to the main interface:

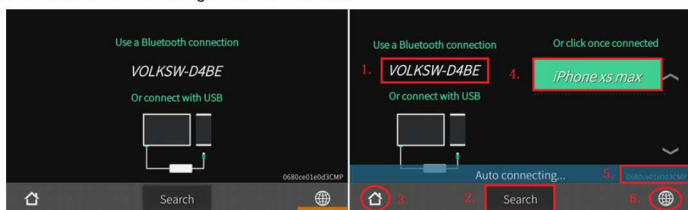

1. Bluetooth name of the box, after connecting to the car audio system, the mobile phone can search for this name to pair and connect.
2. Click "Active Search", the box will search for nearby iPhones with Bluetooth enabled, click the searched device list to pair and connect to the corresponding iPhone
3. Click this icon to return to the car audio system interface.
4. Record of mobile phones connected to the box, click the corresponding mobile phone name to pair and connect to the corresponding mobile phone, long press for three seconds to delete this record.
5. The current version number of the box.
6. Switch the language of the current interface of the box.

#### 2. Instructions for webpage setting interface:

Enter the webpage setting method: iPhone mobile phone connection box wifi, and turn on data traffic to go online, browser input URL: 192.168.50.2, enter the version update and display interface, then click on the bottom or right corner of the page, enter the webpage setting function interface.

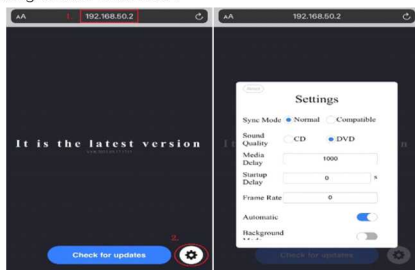

1. Enter the webpage interface.
2. Click to enter the webpage function setting interface.

#### 3. Instructions for setting function page

In this function setting page, you can make some corresponding adjustments according to the actual situation, the two options of synchronization mode and media sound quality, after setting, you need to unplug the box to take effect.

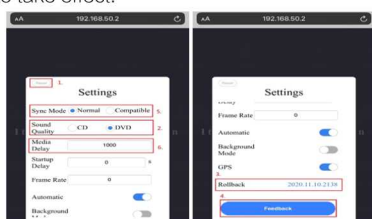

1. Reset: Restore the box to the state it just upgraded to this version, and delete all connection records in the box.
2. Play music after connecting the box, it will become a car audio system with agging noise, you can try to switch the media sound quality. After switching, you must re-plug the box to take effect.
3. The version rolls back to the previous version set by the server.
4. Feedback the problem log during the use of the product to facilitate debugging.
5. Sync mode: It works on some cars that support the CarPlay media information display on the dashboard. When the media information cannot be used normally after using the box, you can try to switch the synchronization mode. At the same time, you can also switch the synchronization mode to try on car models that do not recognize the box. After switching, you must re-plug the box to take effect.
6. Adjust the delay time of media sound: Default 1000 milliseconds, adjust the useful range of 300-2000 milliseconds. The greater the delay, the less likely to be stuck. The smaller the delay, the more synchronized the music and the image. This setting is related to the network environment in the car, please adjust according to the actual situation.

### TWO. Function use:

1. Active search in the box can connect to the mobile phone
  - A. First turn on the Bluetooth and WiFi of the mobile phone.
  - B. Click the active search button on the main interface of the box (Picture010), enter the search device interface (Picture011).
  - C. After searching for a connectable device, click the device name to connect (Picture012).
  - D. When connecting for the first time, corresponding operations are required on the phone,
    1. When there is a Bluetooth pairing request on the mobile phone, click on pairing, otherwise you cannot proceed to the next step (Picture013)
    2. When the mobile phone prompts whether to connect the CarPlay of "\*\*\*\*\*-\*\*\*\*Bluetooth name", choose to use CarPlay (Picture014).

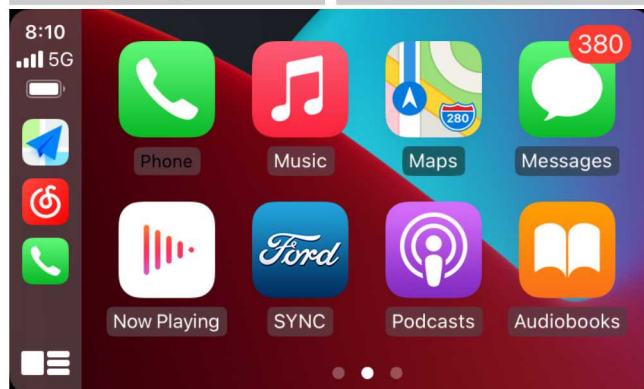
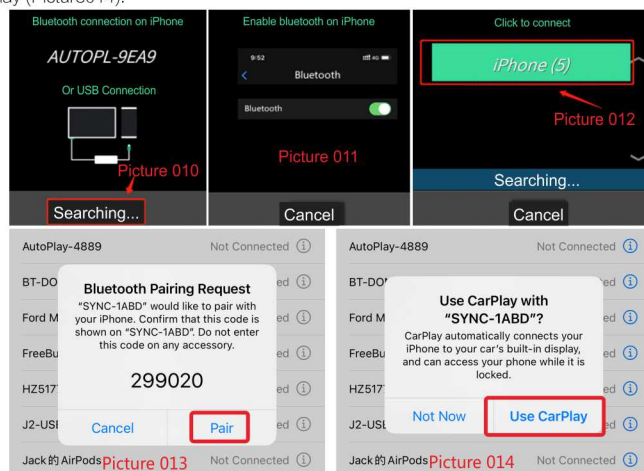

# Online upgrade instructions

Suggestion: The car audio system with higher screen resolution, to ensure normal upgrade, it is recommended to disconnect the carplay connection first, then turn off the mobile phone's Bluetooth, the mobile phone is connected to the box wifi separately, then perform the online upgrade operation, otherwise, the upgrade may fail.

A. The online upgrade requires that the iPhone mobile phone is connected to the wifi from the box that needs to be upgraded, and the mobile phone can access the Internet normally (That is, the cellular data is turned on on the i-phone mobile phone, and the data can be used to surf the Internet) (picture002).

B. Then connecting the iPhone mobile phone which needs to upgrade the wifi of the box, enter the URL in the browser: 192.168.50.2, enter the online upgrade page (picture003).

C. There is a new version in the online upgrade interface, just click to update (Check the update once if there is no new version, that means it has not been updated yet) (picture003).

D. Please do not power off or perform other operations during the upgrade process, so as to avoid upgrade errors and make the box unusable, after the upgrade is complete, the box will automatically disconnect and restart the box (The upgrade progress bar on the mobile phone will go to 100% to indicate that the upgrade is complete) (picture004)(picture005)(picture006).

E. After the upgrade is complete, wait for the box to automatically restart and then reconnect, after the connection is normal, you can enter the webpage again to check whether the version is the latest.

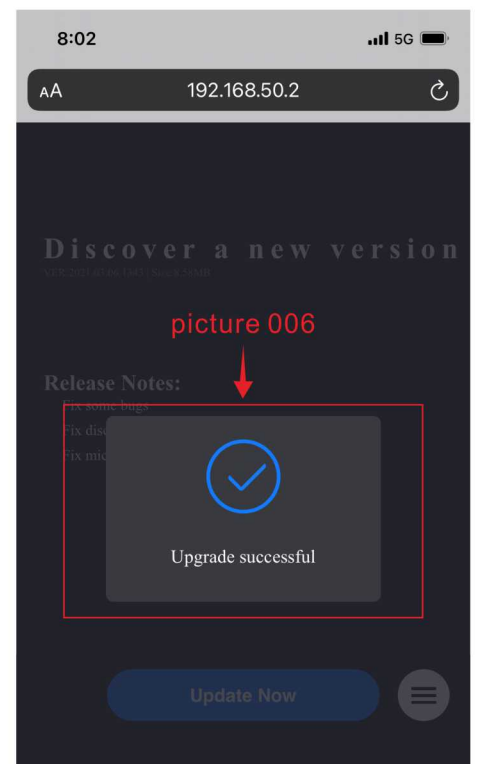
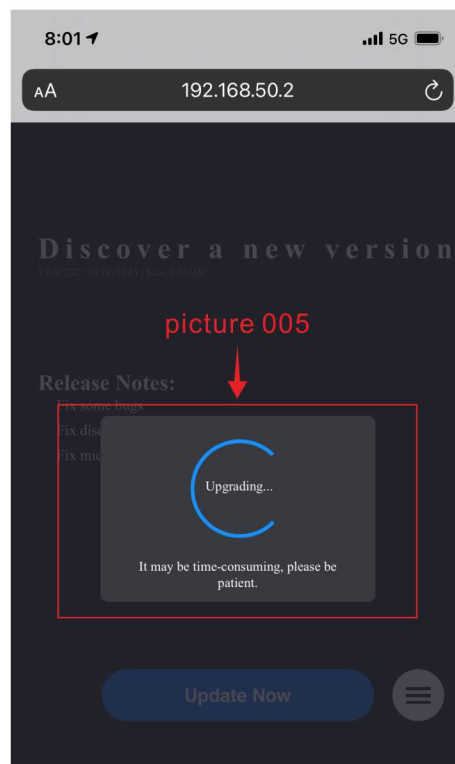
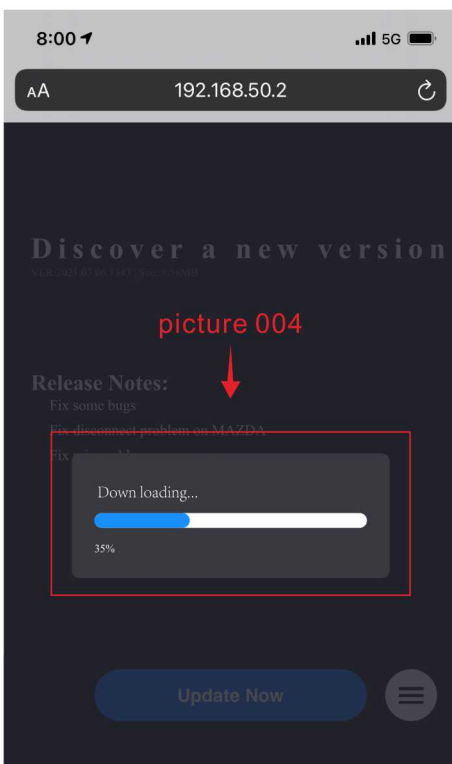
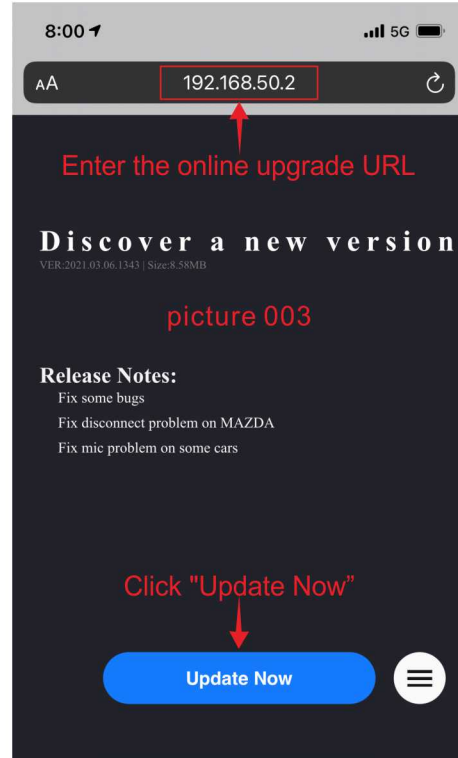





# Wireless CarPlay Dongle

Convert Factory Wired CarPlay to Wireless

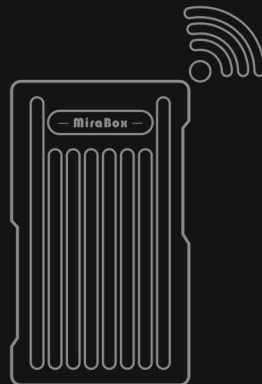

Model : HSV283

## 前置条件：

- 1.HSV283有线无线盒子连接前，请确认您当前使用的设备支持有线连接到I-Phone carplay。
- 2.盒子上对应的接口即可可连接到手机（有些汽车有多个USB端口，有的可能只有一个可以连接手机的，一般都有标识。）

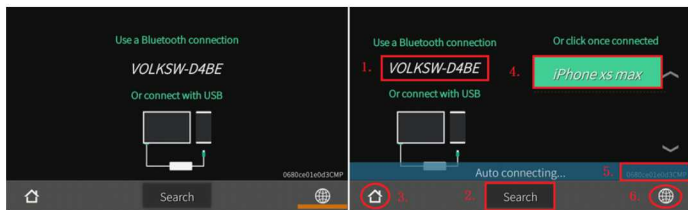

## 一、有线转无线盒子连接主界面与网页设置页说明：

### 1.连接主界面说明图：



- 1.盒子的蓝牙名称，连接汽车音响后，手机可以搜索此名称进行配对和连接。
- 2.点击“Active Search”，该框将搜索附近启用蓝牙的iPhone，点击搜索到的设备列表配对并连接到对应的iPhone
- 3.点击此图标返回汽车音响系统界面。
- 4.记录盒子连接的手机，点击对应的手机名称配对并连接到对应的手机，长按三秒删除这条记录。
- 5.盒子的当前版本号。
- 6.切换盒子当前界面的语言。

### 2.网页设置界面说明：

进入网页设置方法：iPhone 手机连接盒子 wifi 并打开数据流量上网，浏览器输入网址：192.168.50.2，进入版本更新及显示界面，然后再点击网页右下角偏上一点带三条杠的小圆圈或，进入网页设置功能界面。

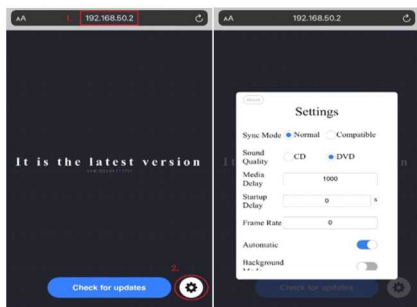

- 1.进入网页界面。
- 2.点击进入网页功能设置界面。

### 3.功能页面设置说明

在该功能设置页面中，您可以根据实际情况进行一些相应的调整，同步模式和媒体音质两个选项，设置完成后需要拔掉盒子才能生效。

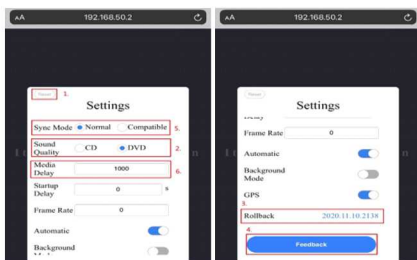

- 1.Reset：将盒子恢复到刚升级到这个版本的状态，并全部删除框中的连接记录。
- 2.连接盒子后播放音乐，它会变成一个有老化噪音的汽车音响系统，您可以尝试切换媒体音质。切换后，必须重新插上盒子才能生效。
- 3.版本回滚到服务器设置的上一个版本。
- 4.反馈产品使用过程中的问题日志，方便调试。
- 5.同步模式：适用于部分支持carplay媒体信息显示的车型仪表盘。当使用盒子后媒体信息不能正常使用时，您可以尝试切换同步模式。同时，您还可以切换同步模式试穿不认框的车型。切换后，你必须重新插上盒子才能生效。
- 6.调整媒体声音的延迟时间：默认1000毫秒，调整有用范围300-2000 毫秒。延迟越大，卡住的可能性就越小。越小延迟，音乐和图像越同步。此设置与网络有关，请根据实际情况调整车内环境。

## 二、功能使用：

- 1.盒子主动搜索可以连接手机
  - A、先打开需要连接的手机的蓝牙与 wifi。
  - B、点击盒子主界面的主动搜寻按键(图 010)，进入搜索设备界面(图 011)。
  - C、搜索到可连接设备后点击设备名称连接(图 012)。
  - D.第一次连接时手机上需要相应的操作
    - 1.当手机出现盒子蓝牙配对请求时，点击配对，否则无法进行下一步(图 013)
    - 2.当手机提示是否连接“\*\*\*\*\*-\*\*\*蓝牙名称”的 carplay 车载时，选使用 carplay 车载(图 014)。
  - E.然后手机就会连上车载无线 carplay(图 015)。

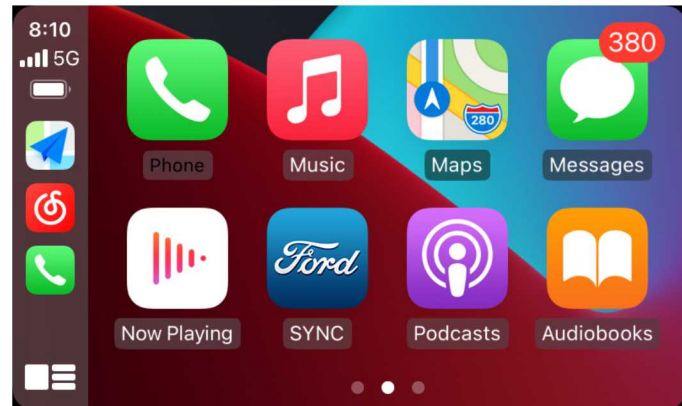
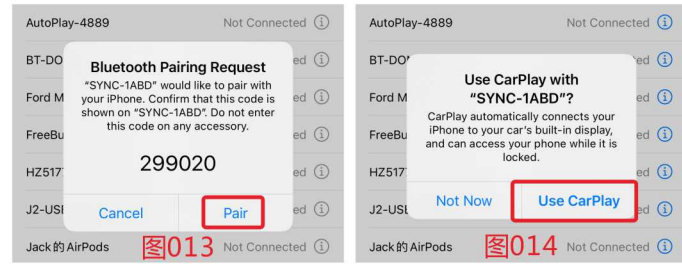

# 在线升级说明:

建议：屏幕分辨率较高的车载音响系统，为保证正常升级，建议先断开carplay连接，然后关闭手机蓝牙，手机单独连接盒子wifi，再进行在线升级操作，否则可能会出现升级失败的情况。

- 在线升级需 iPhone 手机连上了需要升级的盒子发出来的 wifi，并且手机可以正常访问互联网（就是 iPhone 手机打开了蜂窝数据可以用流量上网）（图 002）。
- 然后通过连接了需要升级盒子 wifi 的苹果手机，在浏览器输入网址：192.168.50.2 进入在线升级页面(图 003)。
- 在线升级界面有新版本点击更新即可（检查更新一次没有新版那就是还没更新）(图 004)。
- 升级过程中请不要断电或进行其他操作，以免升级出错导致盒子无法使用，升级完成后盒子会自动断开连接并重启盒子（手机上升级进度条会跑到 100%提示升级完成）。(图005)(图 006)(图 007)。
- 升级完成后等待盒子自动重启在重新连接即可，连接正常后可再次进入网页查看版本是否最新，如果提示已经最新版本了就可以了。。

